



megaspin 3200P

THE FASTEST FULLY AUTOMATIC DIAGNOSTIC WHEEL BALANCER



6,4'' MEASURING CYCLE





6,4''

MEASURING CYCLE

In a single measurement cycle:

- Automatic acquisition of wheel dimensions and correction planes
- Unbalance measurement
- Rim runout measurement
- Tyre runout measurement
- Single-point tread depth measurement
- Hubmatch®
- One Weight Balancing

Touch screen with extremely user-friendly interface



megaspin



Automatic wheel diagnosis

Since the vibrations of a wheel often do not depend only on the imbalance, but on a geometrical defect, the M3200P performs a complete wheel analysis to check the structural difformity. During the measurement launch, the machine, with the external laser, performs a complete wheel diagnosis including rim eccentricity, tire eccentricity, tread-depth and conicity. The machine also recommends the best possible matching to reduce eccentricity. HubMatch, the guided on-car eccentricity cancellation process, detects the highestpoint of the wheel to reduce the assembly eccentricity using hub bore clearance and gravity.



Automatic data input with 3D Laser Scan

The 3D Laser Scan, combined with the external radial laser, measures with high precision the dimensions of any rim profile, without any intervention of the operator. During the correction phase, the 3D Laser Scan pinpoints the exact position for stick-on weights application inside the rim. Any possible error during the weight positioning is avoided thanks, also, to the electric brake, which locks the wheel into the exact correction position. A led light illuminates the working space inside the rim.



Side laser

Two laser beams indicate the exact 12 o'clock position to place clip-on weights. With these accurate reference points, any possibility of error during the positioning of counterweights is eliminated.



One Weight Balancing

One Weight Balancing is automatically activated, at the end of the spin, and suggests a single ideal correction plane instead of two. The laser pointer indicates the exact point where it is possible to balance the wheel minimizing both static and dynamic imbalance, using only one counterweight. OWB offers 30% time savings for 70% of wheels.

Megaclamp - Pneumatic locking

Pneumatic locking ensures perfect wheel centering on the spindle, reducing clamping time.



Instant automatic positioning

With the M3200P, the automatic positioning system with electromagnetic brake on DC motor has been made even more efficient, thanks to the doubled speed which allows the wheel to stop instantly in the correction position. At the end of the measuring spin, the wheel stops automatically at the exact point of counterweight application. After correcting the first plane, by pressing "start", the wheel position itself accurately on the second correction point.



Standard accessories



SE KIT

Ring, quick locking sleeve SE2, SE spacer



3 CONES KIT

Ø 45÷110 mm, pincer-hammer and 60 g counterweight

Optional accessories

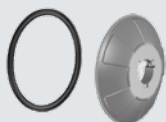

RL CUP Ø 40

Large plastic cup with rubber ring for alloy rims protection

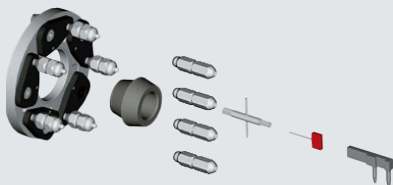

UH20/2 Ø 40

Universal adapter for wheels with 3,4,5,6 holes. Complete with back centering double cone for wheels with/without central holes

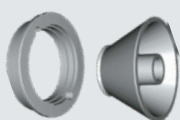

VL/2 CONE + G36 DISC

Kit for light truck wheels (Ø 97÷170 mm centre hole)



MT2 CONE Ø 40

Stepped cone for Porsche - Audi - Opel - Volkswagen - BMW - Smart (Ø56,5 / 57 / 66,5 / 72,5 mm centre hole)



PSA CENTERING KIT

Set of 3 bushes (Ø 58/60/65) + 2 cones (Ø 62÷68 mm and Ø 54÷60 mm). Developed on Peugeot and Citroën specs

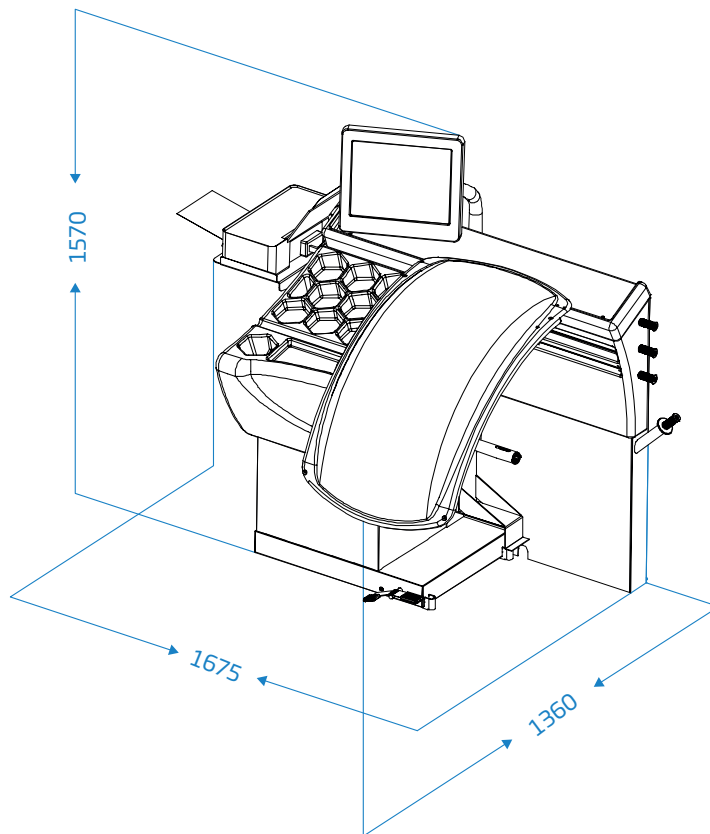

Technical Data

Single phase power supply

230V/1ph/50 hz

115V/1ph/60 Hz

Max. absorbed power

0,15 kW

Balancing speed

100 rpm

Measurement spin time for 15 kg (33 lb) wheel

4.7 s

Measurement uncertainty

± 0,5 g

Resolution

0,5 g

Average noise

< 70 dB (A)

Rim width setting range

1.5" ÷ 20" / 40 ÷ 510 mm

Rim diameter setting range

10" ÷ 30" / 265 ÷ 765 mm

Min./Max. compressed air pressure

7 ÷ 10 kg/cm² / ~ 0.7 ÷ 1 MPa

~ 7 ÷ 10 bar / ~ 105 ÷ 145 psi

Max. wheel weight

< 75 kg

Machine weight

220 kg



OPTIONAL ZERO WEIGHT LIFT TO REDUCE ANY EFFORT

Professional automatic wheel lift with load capacity up to 80 kg.

Zero weight is quick and ensure the exact centring of the wheel.



HOFMANN MEGAPLAN GmbH

Hüttenstrasse 7 - 67550 Worms - Germany

T +49 (0)6242 913 6666 - hm-mail@hofmann-megaplan.com

www.hofmann-megaplan.com